

Atwood® LP Alarm



EFFECTIVE MARCH 2000

 Atwood®

Atwood LP Gas Alarm



LP Gas Alarm Selection Guide

Model	Description	Dimensions																							
		S	A		B		C		D		E		F		G		H								
			Surface Mnt	in.	mm.	Surface Mnt	in.	mm.	Surface Mnt	in.	mm.	Flush Mnt	in.	mm.	Flush Mnt	in.	mm.	Flush Mnt	in.	mm.	Cutout	in.	mm.	Cutout	in.
37761	Surface & Flush Mount 12 VDC	S	13/16	30.0	3	76	3 3/4	95	—	—	—	—	—	—	—	—	—	—	—	1" dia.	25 dia.	—	—	—	—
		F	—	—	—	—	—	—	—	15/16	24	3 7/8	98	45/8	117	3 1/4	83	37/8	99	—	—	—	—	—	—
37762	With Aftermarket pkg.—Surface & Flush Mount 12 VDC	S	13/16	30.0	3	76	3 3/4	95	—	—	—	—	—	—	—	—	—	—	—	1" dia.	25 dia.	—	—	—	—
		F	—	—	—	—	—	—	—	15/16	24	3 7/8	98	45/8	117	3 1/4	83	37/8	99	—	—	—	—	—	—
37921	Surface & Flush Mount 120 Volt AC	S	13/16	30.0	3	76	3 3/4	95	—	—	—	—	—	—	—	—	—	—	—	1" dia.	25 dia.	—	—	—	—
		F	—	—	—	—	—	—	—	15/16	24	3 7/8	98	45/8	117	3 1/4	83	37/8	99	—	—	—	—	—	—
37920	With Aftermarket pkg.—Surface & Flush Mount 120 Volt AC	S	13/16	30.0	3	76	3 3/4	95	—	—	—	—	—	—	—	—	—	—	—	1" dia.	25 dia.	—	—	—	—
		F	—	—	—	—	—	—	—	15/16	24	3 7/8	98	45/8	117	3 1/4	83	37/8	99	—	—	—	—	—	—
37765	Replacement Mounting Flange																								

LP Gas Alarm Dimensions

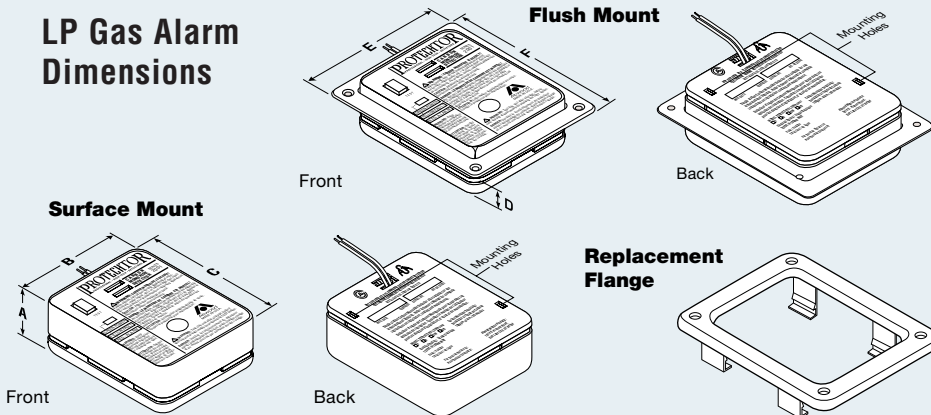

Flush Mount Installation

- Needs minimum 1/2" hole in wall to accommodate power wires on back of unit.
- Secures with two screws provided.
- "D" dimension is the distance from the back of the detector to the bezel. This measurement determines the amount of the part recessed into the wall.

Note: In most cases, dimensions are rounded to 1/8". Drawings and dimensions subject to change without notice. For pricing, contact your Distributor or Atwood Sales Representative. All specifications and illustrations are based on the latest information at the time of publication. Atwood assumes no responsibility for any error in type or print reproduction of specifications in this literature. Due to our policy of continuous improvement, Atwood reserves the right to make changes in price, color, materials, equipment and specifications and to discontinue models at any time without notice.



1120 North Main Street • Elkhart, IN 46514
 PHONE: 574-264-2131 FAX: 574-262-2550
 INTERNET: <http://www.atwoodmobile.com>

